

CBH

FASTENERS

Fastening the world together...



www.capitalbolts.in

*Name an Application and
we have a **fastener** ready for it.*

Capital Bolts and Hardware is a large-scale company specializing in producing standard fasteners. Our company was established in 1959 and is located at Capital Towers, Gill Road, Miller Ganj, Ludhiana, Punjab which is the biggest national fastener distributing center. Our company covers an area of more than ten thousand square meters and is next to the G.T. Road (City Limits). What's more, the transportation here is convenient because the Ludhiana Railway Station is just 2 kms and National Airport Sahnewal (Ludhiana) is 12 kms. away from the company. After many years of development, our company has advanced facilities for producing screw bolts and complete equipment for product inspection.

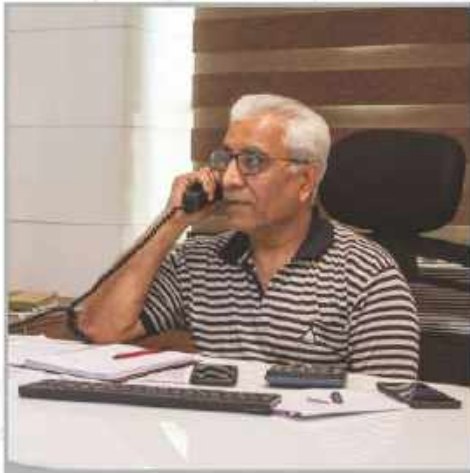

Mr. Satish Kumar Nagpal
Chairman



Mr. Hitesh Nagpal
Director

Our company specializes in producing high strength bolts with large hexagon head for steel structures, high-strength bolts and nuts of grade 4.6, 4.8, 5.6, 6.8, 8.8, 10.9 & 12.9, hot dip galvanizing standard components, electro-galvanized standard components, double threaded bolts, full thread screws, foundation bolts, high quality fasteners as per ANSI, DIN and BS standards, plain cushions, spring cushions, inner-hexagon bolts, iron pagoda bolts and nut sets, guardrail bolts used in expressways and special shaped components with various lengths and specifications of m12 to m68.

We have won an excellent reputation in fastener industry with high quality products and considerate services for a long time. Our products sell well all over our country and are exported to many countries and regions, such as Southeast Asia, the Middle East, Europe and America. What's more, we have received high public praises and our company was awarded titles of "Honor Credit and Promise", "The Leading Enterprise in Fasteners Industry" and "Civilized Enterprise". Our company always adheres to the principle of "quality first and good faith supreme". "To satisfy customers" is our persistent aim. We sincerely welcome the visits of all customers as well as the negotiations with business partners from all over the world.

Our company is vowed to save our environment. So to preserve our Mother Earth, we have started a Green Initiative. We get our products manufactured at environmental friendly premises are coated from ROHS compliant companies and we work with vendors who strictly adhere to affluent treatment and disposal norms. Furthermore, we plant a tree for every new customer who becomes a part of our family. So lets work together as a team to Save Our Environment and do business for each other's growth.



DIN 84 ISO 1207

SLOTTED CHEESE HEAD SCREWS

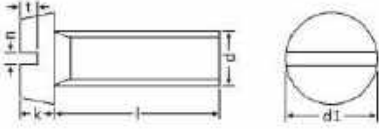

DIN 85 ISO 1580

SLOTTED PAN HEAD SCREWS

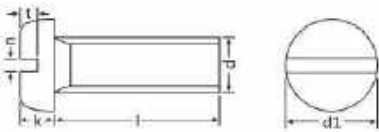

DIN 94 ISO 1234

SPLIT PINS



DIN 95

WOOD SCREWS - RAISED COUNTERSUNK HEAD - SLOTTED

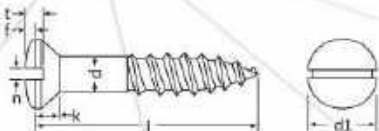

DIN 96

WOOD SCREWS - ROUND HEAD - SLOTTED

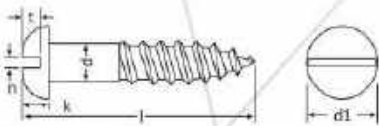

DIN 97

WOOD SCREWS - COUNTERSUNK HEAD - SLOTTED

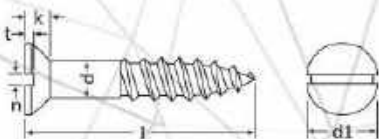

DIN 125A ISO 7089

PLAIN WASHERS TYPE A WITHOUT CHAMFER

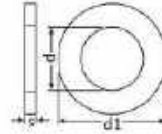

DIN 125B ISO 7090

PLAIN WASHERS TYPE B WITH CHAMFER

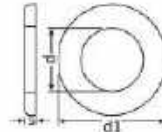

DIN 126 ISO 7091

PLAIN WASHERS

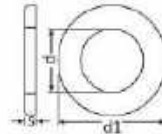

DIN 127

SPRING LOCK WASHERS TYPE B - PLAIN PATTERN

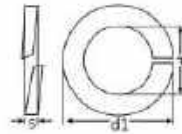

DIN 127B

SPRING LOCK WASHERS

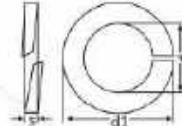

DIN 137A

CURVED SPRING WASHERS

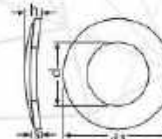



DIN 314 | DIN 315

WING NUTS AMERICAN TYPE - EDGED WINGS

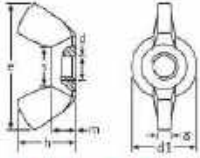

DIN 315

WING NUTS HEAVY TYPE - ROUNDED WINGS

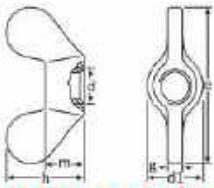

DIN 316 | DIN 318

WING SCREWS AMERICAN TYPE - EDGED WINGS

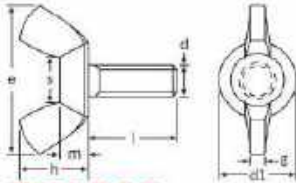

DIN 316

WING SCREWS HEAVY TYPE - ROUNDED WINGS

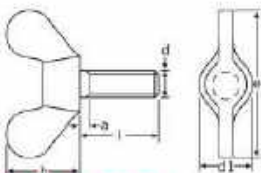

DIN 417 ISO 7435

SLOTTED HEAD SCREWS WITH FULL DOG POINT



DIN 433 ISO 7092

PLAIN WASHERS FOR CHESSE HEAD SCREWS

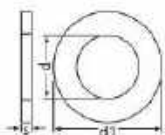

DIN 434

SQUARE TAPER WASHERS FOR U-SECTIONS

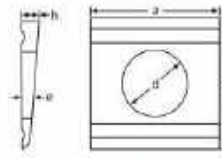

DIN 435

SQUARE TAPER WASHERS FOR I-SECTIONS

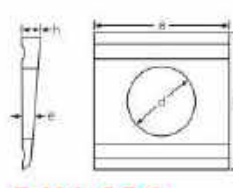

DIN 436

SQUARE WASHERS

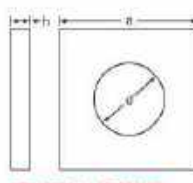

DIN 438 ISO 7436

SLOTTED SET SCREWS WITH CUP POINT

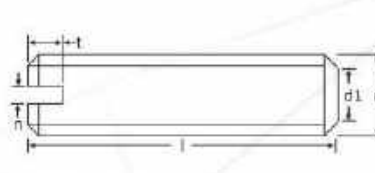

DIN 439 ISO 4035 | ISO 8675

HEXAGON THIN NUT WITH CHAMFER

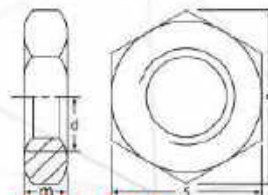

DIN 444

EYE BOLTS TYPE B - MEDIUM COARSE

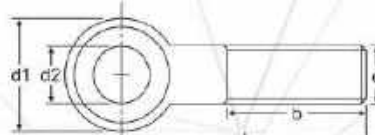



DIN 471

RETAINING RINGS FOR SHAFTS

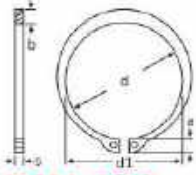

DIN 472

RETAINING RINGS FOR BORES

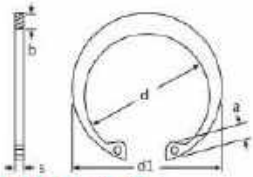

DIN 479

SQUARE HEAD BOLTS

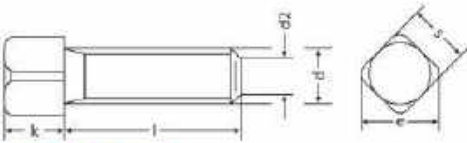

DIN 557

SQUARE NUT

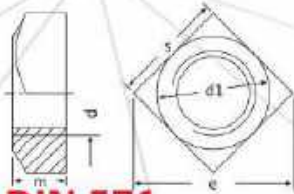

DIN 571

WOOD SCREWS WITH HEXAGON HEAD

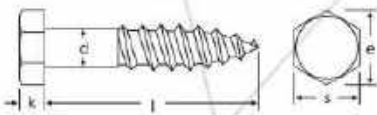

DIN 580

LIFTING EYE SCREWS

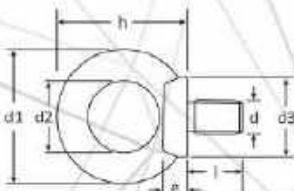

DIN 582

LIFTING EYE NUTS

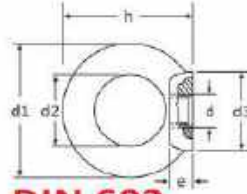

DIN 603

MUSHROOM HEAD SQUARE NECK BOLTS

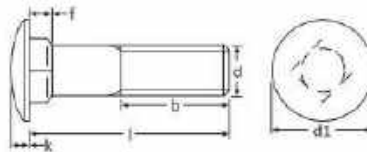

DIN 660

ROUND HEAD RIVETS

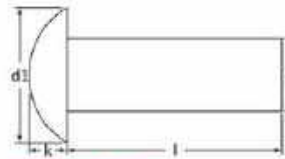

DIN 661

COUNTERSUNK HEAD RIVETS

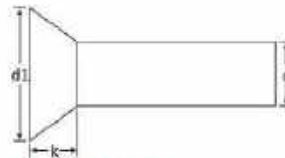

DIN 912 ISO 4762

HEXAGON SOCKET HEAD CAP SCREWS



DIN 913 ISO 4026

HEXAGON SOCKET SET SCREWS WITH FLAT POINT





DIN 914 ISO 4027

HEXAGON SOCKET SET SCREWS
WITH CONE POINT

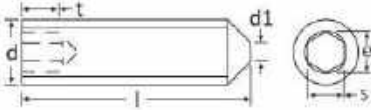

DIN 915 ISO 4028

HEXAGON SOCKET SET SCREWS
WITH DOG POINT

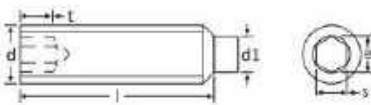

DIN 916 ISO 4029

HEXAGON SOCKET SET SCREWS
WITH CUP POINT

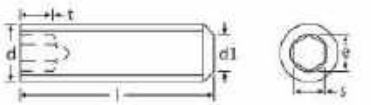

DIN 917

HEXAGON CAP NUTS

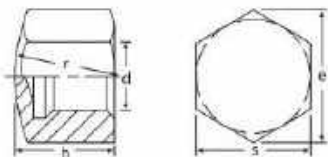

DIN 920

SLOTTED PAN HEAD SCREWS
WITH SMALL HEAD

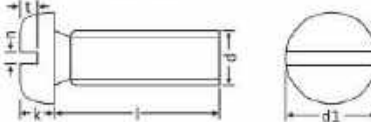

DIN 926 ISO 7435

SLOTTED SET SCREW WITH FULL DOG POINT



DIN 928

SQUARE WELD NUTS

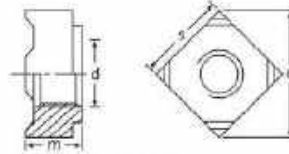

DIN 929

HEXAGON WELD NUTS

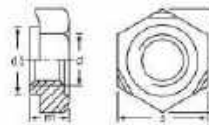

DIN 931 ISO 4014

HEXAGON HEAD SCREWS WITH SHANK

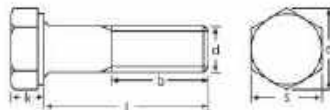

DIN 933 ISO 4017

HEXAGON HEAD SCREWS - FULLY THREADED

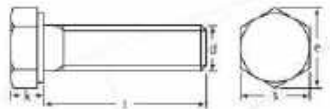

DIN 933 SZ ISO 4017

HEXAGON HEAD SCREWS
WITH SLOT - FULLY THREADED

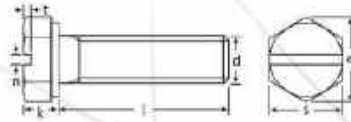

DIN 934 ISO 4032

HEXAGON NUTS

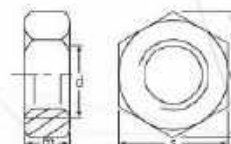



DIN 935

HEXAGON CASTLE NUTS

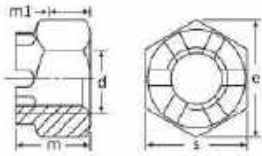

DIN 936

HEXAGON CASTLE NUTS

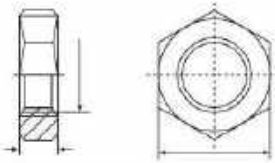

DIN 938

STUDS

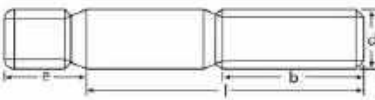

DIN 939

STUDS

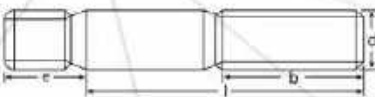

DIN 963 ISO 2009

COUNTERSUNK FLAT HEAD SCREWS - SLOTTED



DIN 964 ISO 2010

RAISED COUNTERSUNK HEAD SCREWS - SLOTTED



DIN 965 ISO 7046

COUNTERSUNK FLAT HEAD SCREWS
CROSS RECESS H PHILLIPS

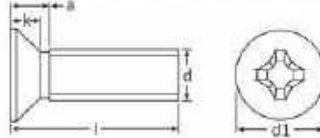

DIN 965 ISO 7046

COUNTERSUNK FLAT HEAD SCREWS
CROSS RECESSED Z POZIDRIV

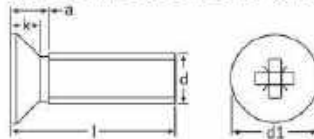

DIN 966 ISO 7047

RAISED COUNTERSUNK HEAD SCREWS
CROSS RECESS H PHILLIPS



DIN 966 ISO 7047

RAISED COUNTERSUNK HEAD SCREWS
CROSS RECESS Z POZIDRIV



DIN 975 | DIN 976

THREAD RODS

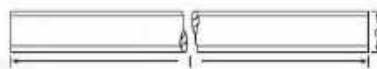

DIN 976A

STUD BOLTS





DIN 979

HEXAGON CASTLE NUTS - THIN TYPE

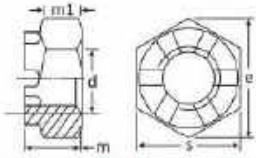

DIN 980 ISO 7042

HEXAGONAL NUT - PREVAILING TORQUE TYPE

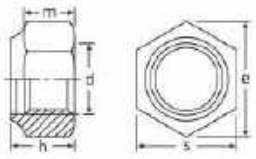

DIN 982 ISO 7040

PREVAILING TORQUE TYPE HEXAGONAL NUT
NON METALLIC INSERT HIGH TYPE

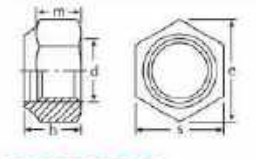

DIN 986

PREVAILING TORQUE TYPE HEXAGON
DOMED CAP NUT NON-METALLIC INSERT

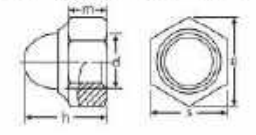

DIN 985 ISO 10511

PREVAILING TORQUE TYPE HEXAGONAL NUT
NON METALLIC INSERT THIN TYPE

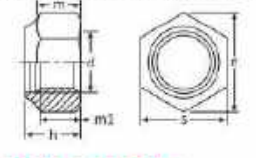

DIN 1587

HEXAGON DOMED CAP NUTS - HIGH TYPE

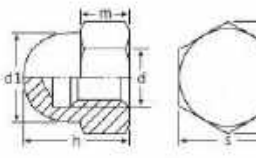

DIN 6330

HEXAGON NUTS

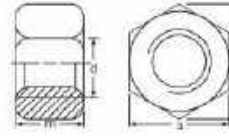

DIN 6331

HEXAGON NUTS WITH COLLAR

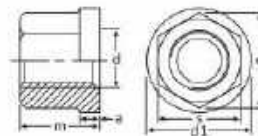

DIN 6334

HEXAGON NUTS

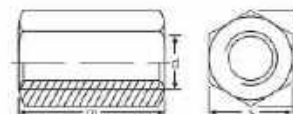

DIN 6796

CONICAL SPRING WASHERS

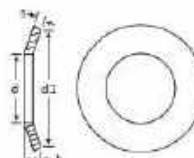

DIN 6797

TOOTHED LOCK WASHERS

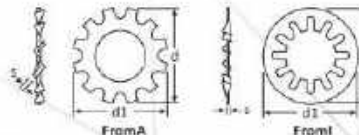

DIN 6798

SERRATED LOCK WASHERS

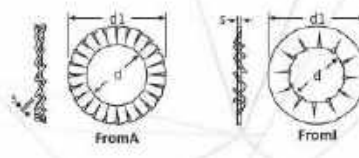



DIN 6798 V

SERRATED LOCK WASHERS
TYPE V FOR COUNTERSUNK HEAD SCREWS

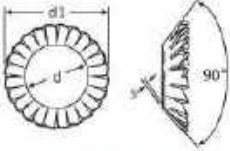

DIN 6799

RETAINING WASHERS FOR SHAFTS

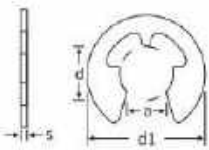

DIN 6912

HEXAGON SOCKET HEAD CAP SCREWS
LOW HEAD AND PILOT RECESS

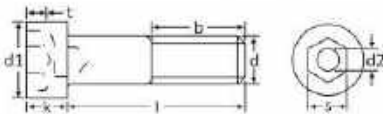

DIN 6917

SQUARE TAPER WASHERS

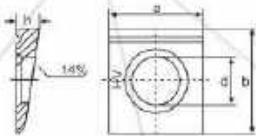

DIN 6918

SQUARE TAPER WASHERS

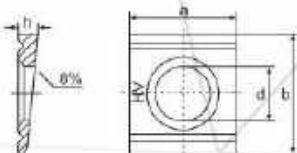

DIN 6921 ISO 15071

HEXAGON HEAD SCREWS WITH
FLANGE AND SERRATION

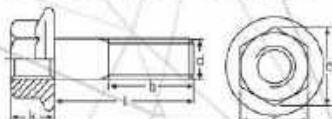

DIN 6923 ISO 4161

HEXAGON FLANGE NUTS

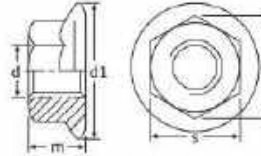

DIN 7337 ISO 15983

BLIND RIVETS - TYPE A PAN HEAD

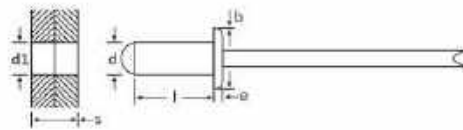

DIN 7343 ISO 8750

SPRING - TYPE STRAIGHT PINS

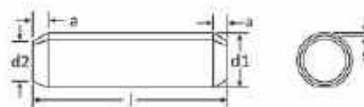

DIN 7346 ISO 13337

SPRING - TYPE STRAIGHT PINS LIGHT TYPE

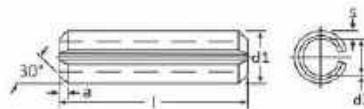

DIN 7500 CZ

THREAD ROLLING SCREWS TYPE C
HEAD DIN 7985 - CROSS RECESSED Z POZIDRIV

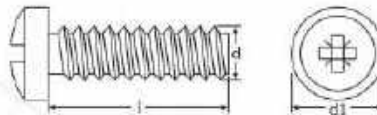

DIN 7500 MZ

THREAD ROLLING SCREWS TYPE M
HEAD DIN 965 - CROSS RECESSED Z POZIDRIV

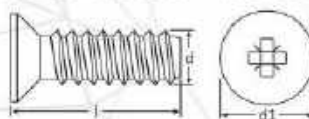



DIN 7504 K ISO 15480

SELF DRILLING SCREWS HEXAGONAL HEAD WITH FLANGE TYPE K

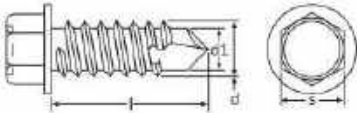

DIN 7504 MZ ISO 15481

SELF DRILLING SCREWS PAN HEAD TYPE M CROSS RECESSED Z POZIDRIV

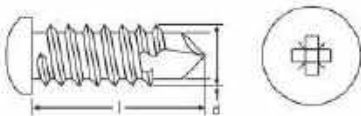

DIN 7504 OZ ISO 15482

SELF DRILLING SCREWS COUNTERSUNK HEAD TYPE O CROSS RECESSED Z POZIDRIV

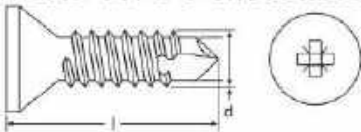

DIN 7967

SELF LOCKING COUNTER NUTS

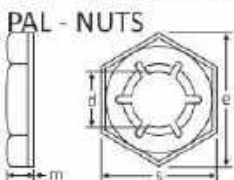

DIN 7971 ISO 1481

TAPPING SCREWS PAN HEAD - SLOTTED TYPE C WITH CONE POINT

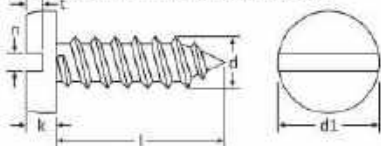

DIN 7972 ISO 1482

TAPPING SCREWS COUNTERSUNK HEAD SLOTTED TYPE C WITH CONE POINT

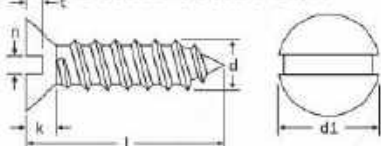

DIN 7973 ISO 1483

TAPPING SCREWS RAISED COUNTERSUNK HEAD SLOTTED TYPE C WITH CONE POINT

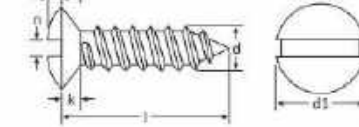

DIN 7976 ISO 1479

TAPPING SCREWS HEXAGON HEAD TYPE C WITH CONE POINT

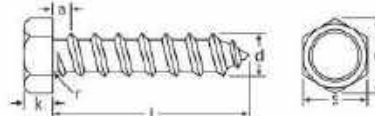

DIN 7976 SZ ISO 1479 SZ

TAPPING SCREWS HEXAGON HEAD SLOTTED - TYPE C WITH CONE POINT

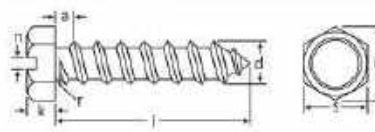

DIN 7980

SPRING LOCK WASHERS FOR SCREWS WITH CYLINDRICAL HEAD



DIN 7981 CH ISO 7049

TAPPING SCREWS PAN HEAD CROSS RECESSED H PHILLIPS - TYPE C WITH CONE POINT

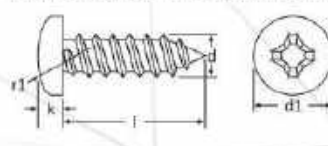

DIN 7981 CZ ISO 7049

TAPPING SCREWS PAN HEAD CROSS RECESSED Z POZIDRIV - TYPE C WITH CONE POINT

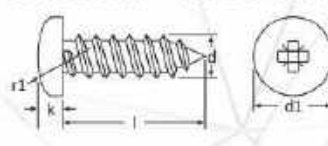



DIN 7981 FH ISO 7049

TAPPING SCREWS PAN HEAD CROSS RECESSED
H PHILLIPS - TYPE F WITH DOG POINT

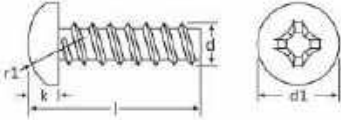

DIN 7981 FZ ISO 7049

TAPPING SCREWS PAN HEAD CROSS RECESSED
Z POZIDRIV - TYPE F WITH DOG POINT

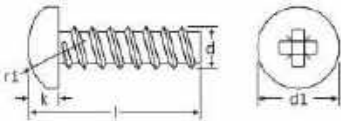

DIN 7982 CH ISO 7050

TAPPING SCREWS COUNTERSUNK HEAD CROSS
RECESSED H PHILLIPS - TYPE C WITH CONE POINT

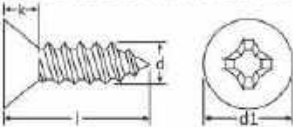

DIN 7982 CZ ISO 7050

TAPPING SCREWS COUNTERSUNK HEAD
CROSS RECESSED Z POZIDRIV - TYPE C WITH CONE POINT

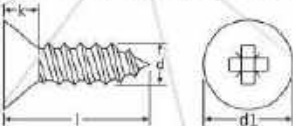

DIN 7982 ISO 14586

TAPPING SCREWS COUNTERSUNK HEAD
SIX LOBE DRIVE - TYPE C WITH CONE POINT

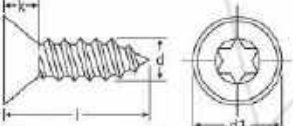

DIN 7982 FH ISO 7050

TAPPING SCREWS COUNTERSUNK HEAD
CROSS RECESSED H PHILLIPS - TYPE F WITH DOG POINT

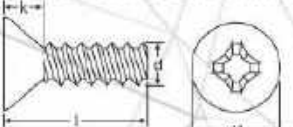

DIN 7982 FZ ISO 7050

TAPPING SCREWS COUNTERSUNK HEAD
CROSS RECESSED Z POZIDRIV - TYPE F WITH DOG POINT

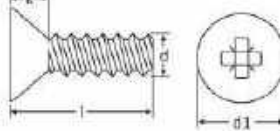

DIN 7983 CH ISO 7051

TAPPING SCREWS RAISED COUNTERSUNK HEAD
CROSS RECESSED H PHILLIPS - TYPE C WITH CONE POINT

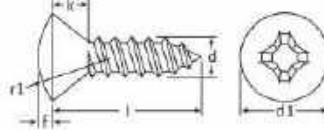

DIN 7983 CZ ISO 7051

TAPPING SCREWS RAISED COUNTERSUNK HEAD
CROSS RECESSED Z POZIDRIV - TYPE C WITH CONE POINT

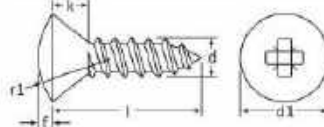

DIN 7983 FH ISO 7051

TAPPING SCREWS RAISED COUNTERSUNK HEAD
CROSS RECESSED H PHILLIPS - TYPE F WITH DOG POINT

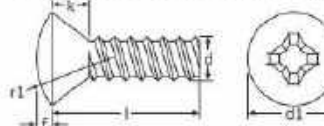

DIN 7984

HEAD SOCKET HEAD CAP SCREWS
LOW HEAD

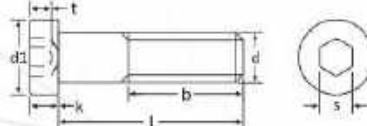

DIN 7985 ISO 7045

PAN HEAD SCREWS
CROSS RECESSED H PHILLIPS

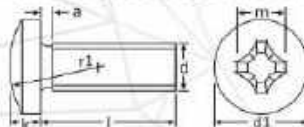



DIN 7985 ISO 7045

PAN HEAD SCREWS
CROSS RECESSED Z POZIDRIV

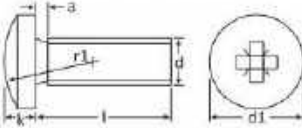

DIN 7985 ISO 14583

PAN HEAD SCREWS - SIX LOBE DRIVE

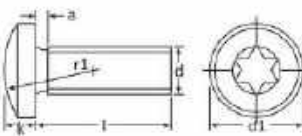

DIN 7991 ISO 10462

HEAD SOCKET COUNTERSUNK HEAD SCREWS

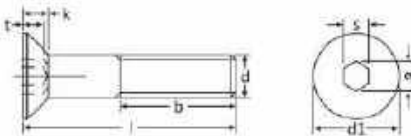

DIN 7995

WOOD SCREWS RAISED COUNTERSUNK HEAD
CROSS RECESSED Z POZIDRIV

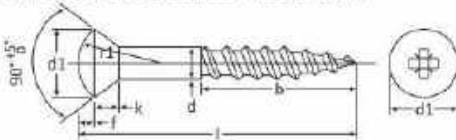

DIN 7996

WOOD SCREWS ROUND HEAD
CROSS RECESSED Z POZIDRIV

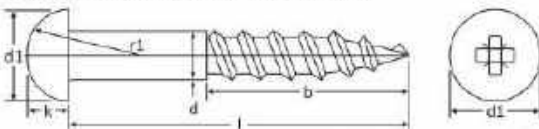

DIN 7997

WOOD SCREWS COUNTERSUNK HEAD
CROSS RECESSED Z POZIDRIV

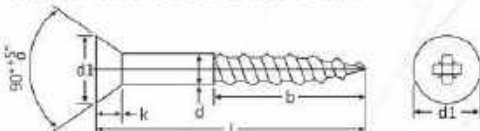

DIN 9021 ISO 7093

PLAIN WASHERS

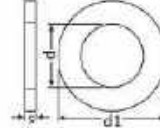

DIN 15237

BELTING BOLTS

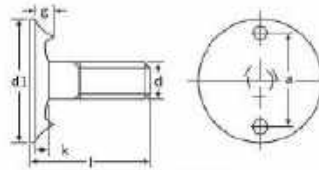

ASTM A193

B7 STUDS | BOLTS

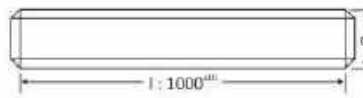

ASTM A194

HEX NUTS

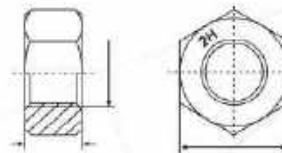

WEDGE ANCHORS

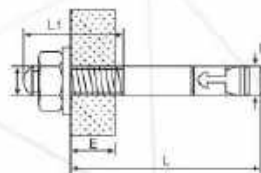

HIGH LOAD ANCHORS - BOLT TYPE

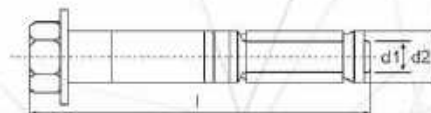



DROP IN ANCHORS

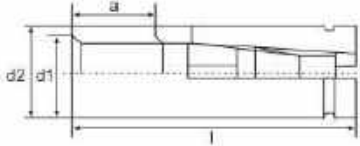

BLIND RIVET NUTS WITH CYLINDRICAL HEAD

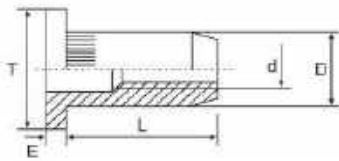

BLIND RIVET NUTS WITH COUNTERSUNK HEAD

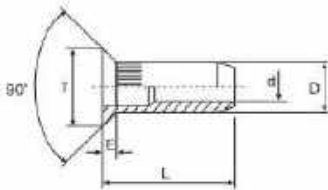

NO SPRING CHANNEL NUTS



SHORT | CONICAL SPRING CHANNEL NUTS

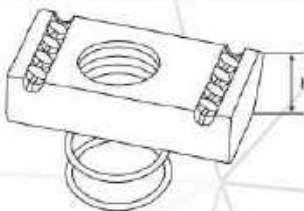

LONG SPRING CHANNEL NUTS

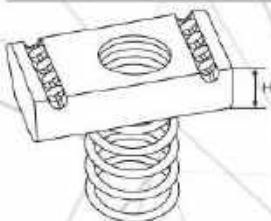

EXTRA LONG SPRING CHANNEL NUTS

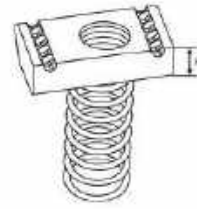

TOP SPRING CHANNEL NUTS



STRUT NUT WITH SPRING & STUD BOLT

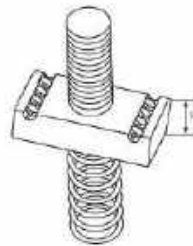

CHANNEL NUT

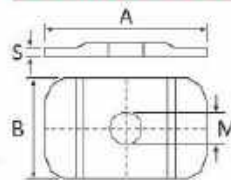

CHANNEL NUT

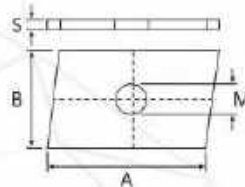

CHANNEL NUT

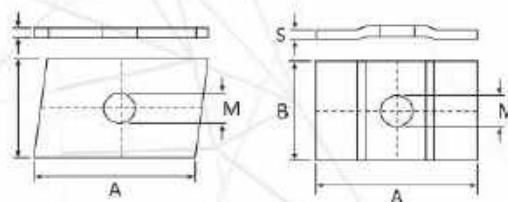



CHANNEL NUT

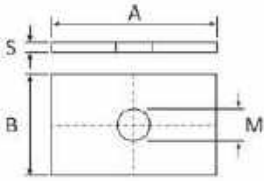

CHANNEL NUT HAMMER HEAD BOLT ASSEMBLY

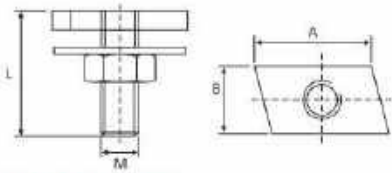

U-BOLTS

M8 | M10 FOR FIXING POLES

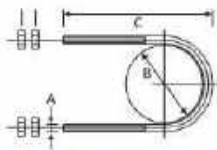

U-BOLTS

STANDARD SHAPE

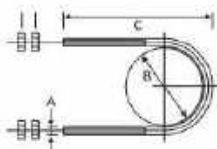

U-BOLTS

LONG LENGTH ARM

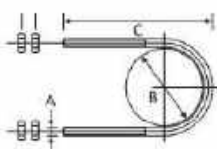

U-BOLTS

ROUND BEND

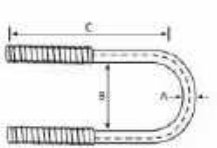

U-BOLTS

SQUARE BEND

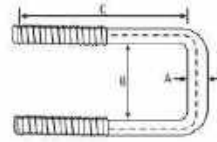

V-BOLTS

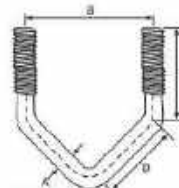

J-BOLTS

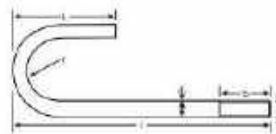

L-BOLTS

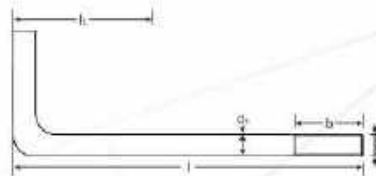

HAMMER HEAD SCREWS

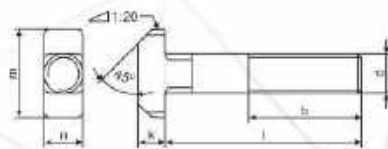

HAMMER HEAD SCREWS

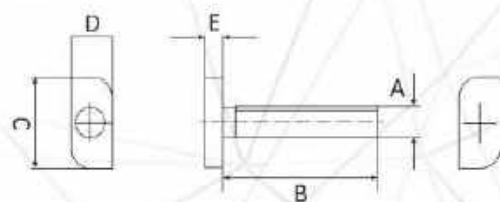



SADDLE BOLTS

FOR FIXING RAILS



WEDGE NUT

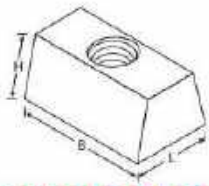

GATE CATCHES

MEDIUM

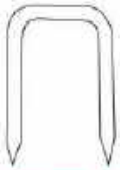

GATE CATCHES

HEAVY DUTY



SPRING PINS

DOUBLE COIL

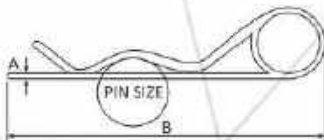

SPRING PINS

SINGLE COIL

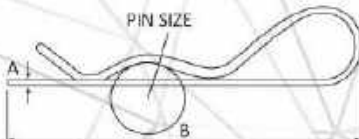

HAIR CLIPS

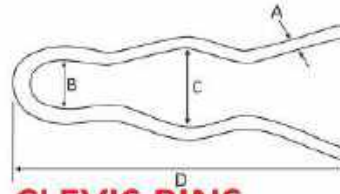

CLEVIS PINS

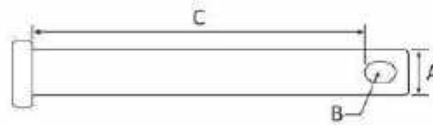

TURNBUCKLES

HOOK & EYE

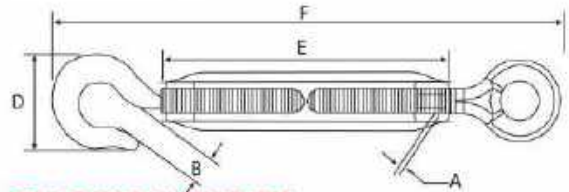

TURNBUCKLES

HOOK & HOOK

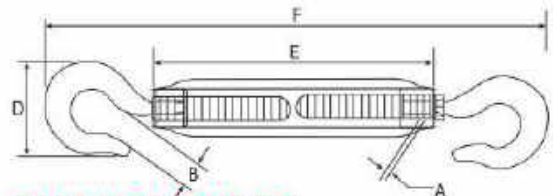

TURNBUCKLES

EYE & EYE

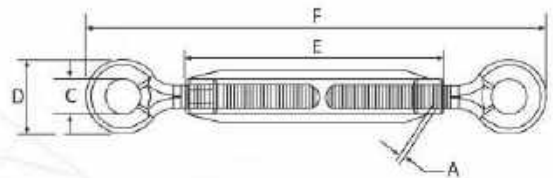



We Produce
We Source
We Deliver

CAPITAL BOLTS AND HARDWARES

(AN ISO 9001 : 2008 CERTIFIED COMPANY)

Corporate Office : Capital Towers, Opp. SBI, Gill Road,
Ludhiana - 141 003 PUNJAB - INDIA.

Works : Vill. Jandiali, Budhewal Road,
Ludhiana Chandigarh Highway,
Ludhiana - 141 112 PUNJAB - INDIA.

Helpline : +91-98880-21000

Phone : +91-161-5012000, 2531717, 2533583

Email : info@capitalhardwares.com
info@capitalbolts.in
hitesh.capital@gmail.com

Website : www.capitalhardwares.com
www.capitalbolts.in